



Kenilworth Close

Borehamwood, WD6 1QF

£499,950 Freehold

Located within a private cul-de-sac on the favoured 'Southside of Borehamwood within moments of Yavneh College and Primary School. This extremely spacious three bedroom house has been the subject of a rear extension and the owners have created a home of distinguished specification with the emphasis on elegance and style. The ground floor comprises of a double length reception area with French doors leading to the garden and a guest cloakroom. The modern fitted kitchen also leads to the garden and to a separate utility/office. The first floor provides three decent sized bedrooms and a luxury family bathroom. The garden is neat and well maintained and there is also a garage in a nearby block. Neighbouring properties have also been the subject of larger extensions and loft conversions (subject to planning consents).

- Three Bedrooms
- Guest Cloakroom
- Double Reception
- Smart Kitchen/Separate Utility
- Long and Neat Garden
- Moments To Yavneh
- Garage

Viewing

Please contact our Carrington Estate Agents Office on 02089531818 if you wish to arrange a viewing appointment for this property or require further information.

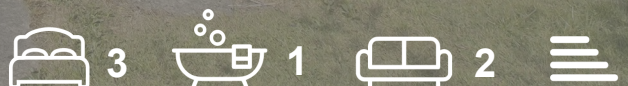

Floor Plan

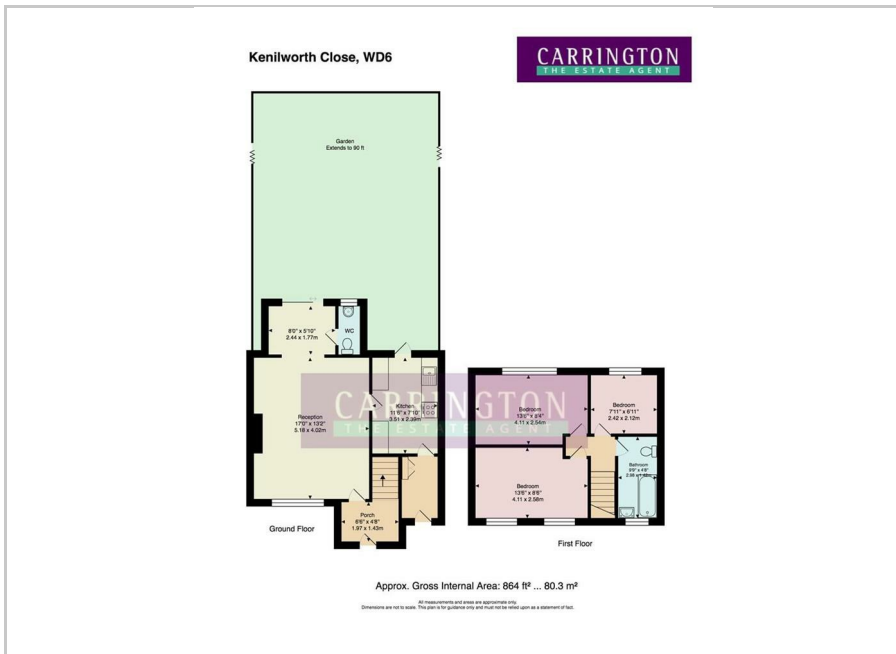

Area Map

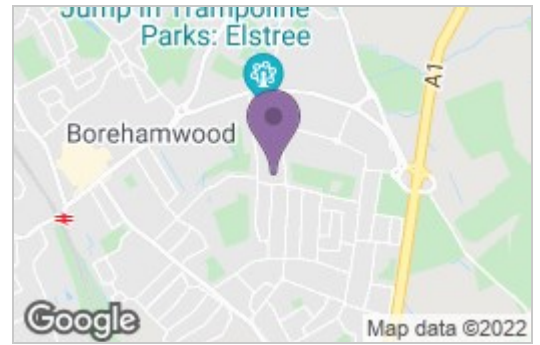

Energy Efficiency Graph

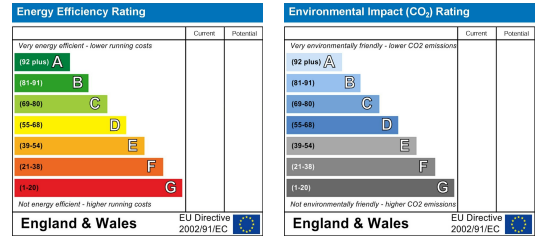

These particulars, whilst believed to be accurate are set out as a general outline only for guidance and do not constitute any part of an offer or contract. Intending purchasers should not rely on them as statements of representation of fact, but must satisfy themselves by inspection or otherwise as to their accuracy. No person in this firm's employment has the authority to make or give any representation or warranty in respect of the property.

138 Shenley Road, Borehamwood, Hertfordshire WD6 1EF
Tel: 020 8953 1818 Fax: 020 8953 0808

Email: info@carrington-borehamwood.co.uk Website: www.carrington-borehamwood.co.uk



COMPANY DIRECTOR: E. A. HUSSAIN
REGISTERED ADDRESS: 1 WARNER HOUSE, HARROVIAN BUSINESS VILLAGE,
BESSBOROUGH ROAD, HARROW, MIDD., HA1 3EX.
COMPANY REGISTRATION No: 09830132